

0F3SR450C220000

SLIPPER CLUTCH KIT FOR MV AGUSTA F4 1000 R

ASSEMBLY INSTRUCTIONS

- Pre-assemble the hub pack: take the hub (0F3SR450C22A01C) and place at the bottom of the grooves the 6 steel balls (001MG025) using a small amount of grease. With an M6 screw fix the clutch drum (0F3SR450C22A02C) onto the clutch hub (0F3SR450C22A01C) in an at-rest position.
- Insert the hub pack onto the main shaft.
 - Replace the original clutch plates. **NOTE: DO NOT insert the two rings (one flat and one concave) to be found in the original disc pack.** The total thickness of the plates should be $48 \pm 0,3$ mm.
 - Remove the screw used to hold hub (0F3SR450C22A01C) and drum (0F3SR450C22A02C) together.
 - Position the drum stopper hub (0F3SR450C22A009) on the hub (0F3SR450C22A01C) with a small quantity of grease taking care to align the three holes with the three pins (0F3CR620E070038) inserted in the hub (0F3SR450C22A01C). Then check that the pins (0F3CR620E070038) do not stick out from the surface where the spring stopper hub (0F3SR450C220007) will be placed.
 - Verify that the secondary spring support (0F3SR540B140016) is well inserted into its own housing inside the drum (0F3SR450C22A02C).
 - Insert the secondary spring (0S2085) in its seat into the drum (0F3SR450C22A02C) with some grease.
 - Verify that the primary spring support (003SUZ118) is well inserted in its own housing inside the pressure plate (0F3SR230C220003).
 - Insert the Evoluzione Racing spring (0S1125) into the pressure plate (0F3SR230C220003).
 - In order, assemble the complete spring stopper kit starting from the spring stopper washer (0F3SR620E070008) with the shaped part facing up as shown in the picture. Insert the load bearing (003MG007) and the spring stopper hub (0F3SR450C220007).
 - Finally, place the complete spring stopper pack inside the Evoluzione racing spring (0S1125) beforehand mounted onto the pressure plate (0F3SR230C220003). At this point insert the pressure plate (0F3SR230C220003) on the drum (0F3SR450C22A02C).
 - Insert the notched washer (0F3SR450B220017) in the relevant opening placed on the upper part of the spring stopper hub (0F3SR450C220007), with the convex part facing up, then insert and screw the nut (0F3SR450A220013). Lock with the dynamometric key to the torque suggested by the manufacturer.
 - Assemble the complete bearing rest: fit in the bearing rest (0F3SR450C220004) the original bearing.
 - Position the bearing rest (0F3SR450C220004) into the relevant opening of the pressure plate (0F3SR230C220003) taking care to correctly align the openings and fix it with the six screws (901VT018) and with the toothed washers (901RD007).

NB: once the assembly is complete, repeatedly operate the clutch lever to check that pressure plate correctly performs the opening and closing movements.

GENERAL SAFETY REGULATIONS

THIS SHEET REPORTS THE INSTRUCTIONS TO CORRECTLY PERFORM THE MAIN CLUTCH ASSEMBLY PROCEDURES.
STM RESERVES THE RIGHT TO MODIFY THE PRODUCT AT ANY TIME AND WITHOUT NOTIFICATION.
THE ASSEMBLY OPERATIONS MUST BE SCRUPULOUSLY OBSERVED AND CARRIED OUT BY A SKILLED TECHNICIAN.
BEFORE INSTALLING THE CLUTCH AN INSPECTION MUST BE CARRIED OUT TO VERIFY THE PRESENCE OF DEFAULTS OR ANOMALIES OF THE VEHICLE.
MAKE SURE THAT THERE ARE NO MISSING OR DAMAGED PARTS IN THE PACKAGE.
SOME PARTS OF THE CLUTCH OR OF THE CLUTCH COMPONENTS CAN PRESENT A SHARP SURFACE. PLEASE HANDLE WITH CARE.
SOME CLUTCH COMPONENTS ARE SMALL AND COULD BE SWALLOWED. KEEP AWAY FROM CHILDREN



STRADA S.r.l.

Via Campo Archero 20 10023 Chieri (TO)
Tel +39 011 9422832 Fax +39 011 9471447
Internet :www.stm.to.it E-mail : strada@stm.to.it

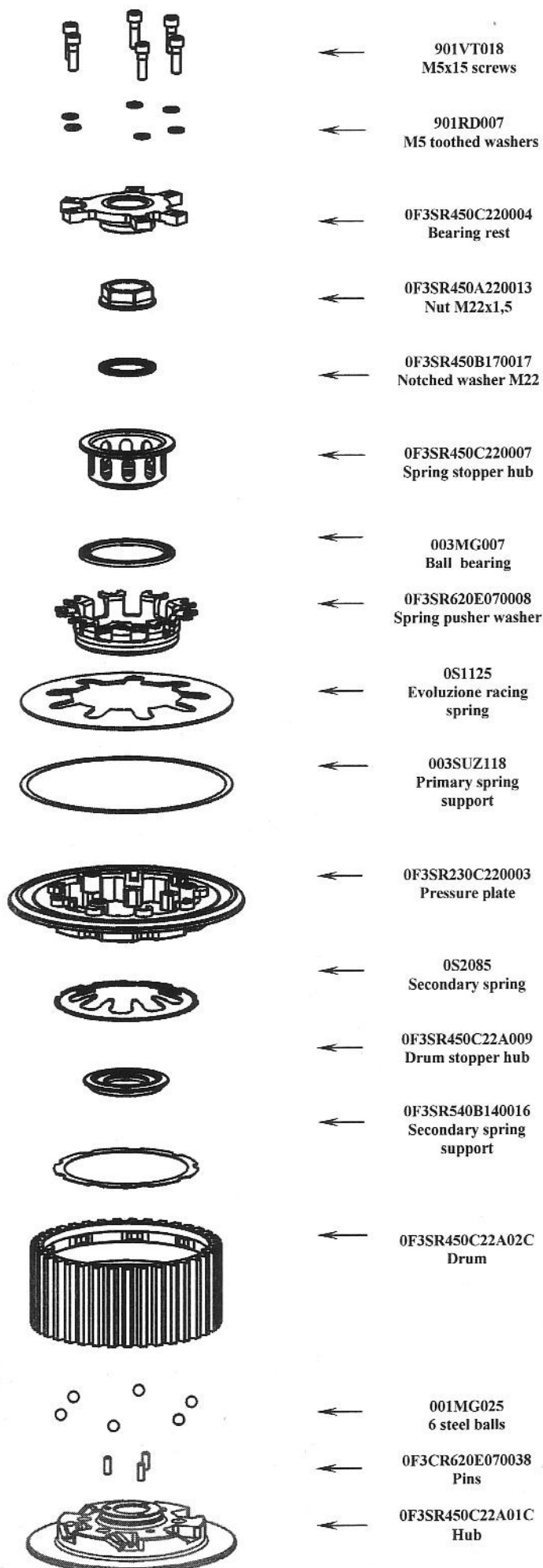

0F3SR450A220000

SLIPPER CLUTCH KIT FOR MV AGUSTA F4 1000, BRUTALE 910 e BRUTALE 750 with M22x1,5 shaft threading

ASSEMBLY INSTRUCTIONS

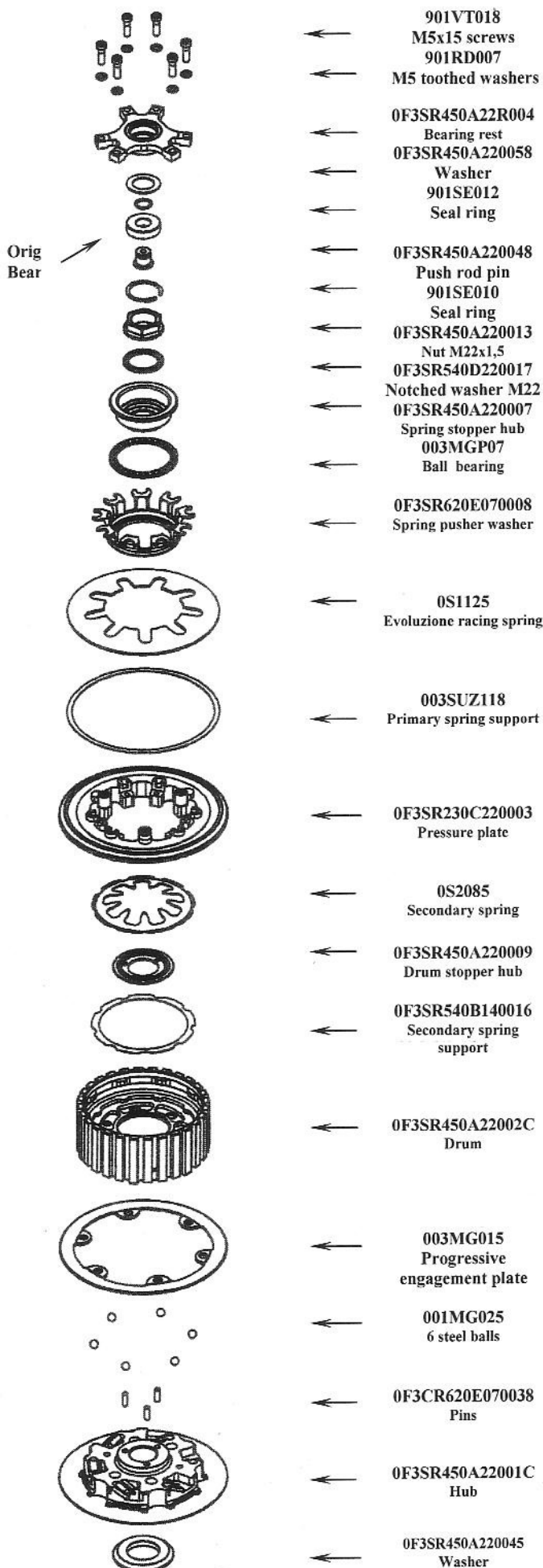

- Pre-assemble the hub pack: put progressive engagement plate (003MG015) on hub (0F3SR450A22001C), with the step facing up, put it correctly into its seats, then check that pushing on one side the other side lifts up.
- place at the bottom of the grooves the 6 steel balls (001MG025) onto the hub (0F3SR450A22001C) using a small amount of grease. With an M6 screw fix the clutch drum (0F3SR450A22002C) onto the clutch hub (0F3SR450A22001C) in an at-rest position.
- Make sure that the washer of the original clutch, placed in the basket, is replaced by the STM washer (0F3SR450A220045) included in the package.
- Insert the hub pack onto the main shaft.
- Reinstall the clutch plates remembering to remove the two rings and to respect the position as in the original clutch. The total thickness of the disc pack should be 42.5 mm.
- Remove the screw used to hold hub (0F3SR450A22001C) and drum (0F3SR450A22002C) together.
- Insert the drum stopper hub (0F3SR450A220009) into the hub housing (0F3SR450A22001C) taking care that the three pins (0F3CR620E070038) inside the hub (0F3SR450A22001C) place themselves in the three holes present on the drum stopper hub (0F3SR450A220009) and that they are on a level with the superior surface of the drum stopper hub.
- Verify that the secondary spring support (0F3SR540B140016) is well inserted into its own housing inside the drum (0F3SR450A22002C).
- Insert the secondary spring (OS2085) in its seat into the drum (0F3SR450A22002C) with some grease.
- Verify that the primary spring support (003SUZ118) is well inserted in its own housing inside the pressure plate (0F3SR230C220003).
- Insert the Evoluzione Racing spring (OS1125) into the pressure plate (0F3SR230C220003).
- In order, assemble the complete spring stopper kit starting from the spring stopper washer (0F3SR620E070008) with the shaped part facing up as shown in the picture. Insert the load bearing (003MGP07) and the spring stopper hub (0F3SR450A220007).
- Finally, place the complete spring stopper pack inside the Evoluzione racing spring (OS1125) beforehand mounted onto the pressure plate (0F3SR230C220003). At this point insert the pressure plate (0F3SR230C220003) on the drum (0F3SR450A22002C).
- Insert the notched washer (0F3SR540D220017) in the relevant opening placed on the upper part of the spring stopper hub (0F3SR450A220007), with the convex part facing up, then insert and screw the nut (0F3SR450A220013). Lock with the dynamometric key to the torque suggested by the manufacturer.
- Assemble the complete bearing rest: insert the washer (0F3SR450A220058) in its seat in the bearing rest (0F3SR450A22R004) and then fit in the original bearing. After that insert the seal ring (901SE010) in the groove inside the bearing rest (0F3SR450A22R004). After putting the push rod pin (0F3SR450A220048) in the original bearing, insert the seal ring (901SE012) in its inner groove.
- Position the bearing rest (0F3SR450A22R004) into the relevant opening of the pressure plate (0F3SR230C220003) taking care to correctly align the openings and fix it with the six screws (901VT018) and with the toothed washers (901RD007) with a torque of 2-3Nm.

NB: once the assembly is complete, repeatedly operate the clutch lever to check that pressure plate correctly performs the opening and closing movements.

GENERAL SAFETY REGULATIONS

THIS SHEET REPORTS THE INSTRUCTIONS TO CORRECTLY PERFORM THE MAIN CLUTCH ASSEMBLY PROCEDURES.
STM RESERVES THE RIGHT TO MODIFY THE PRODUCT AT ANY TIME AND WITHOUT NOTIFICATION.
THE ASSEMBLY OPERATIONS MUST BE SCRUPULOUSLY OBSERVED AND CARRIED OUT BY A SKILLED TECHNICIAN.
BEFORE INSTALLING THE CLUTCH AN INSPECTION MUST BE CARRIED OUT TO VERIFY THE PRESENCE OF DEFAULTS OR ANOMALIES OF THE VEHICLE.
MAKE SURE THAT THERE ARE NO MISSING OR DAMAGED PARTS IN THE PACKAGE.
SOME PARTS OF THE CLUTCH OR OF THE CLUTCH COMPONENTS CAN PRESENT A SHARP SURFACE: PLEASE HANDLE WITH CARE.
SOME CLUTCH COMPONENTS ARE SMALL AND COULD BE SWALLOWED: KEEP AWAY FROM CHILDREN.



STRADA S.r.l.

Via Campo Archero 20 - IT 10023 Chieri TO

Tel +39 011 9422832

Fax +39 011 9471447

Internet: www.stm.to.it

E-mail: info@stm.to.it

0F3SR450B170000

SLIPPER CLUTCH KIT FOR MV AGUSTA F4 750 "gold series" and MV AGUSTA BRUTALE 750 with M25X1,5 clutch shaft threading

ASSEMBLY INSTRUCTIONS

Original
bearing
sp. 8 mm

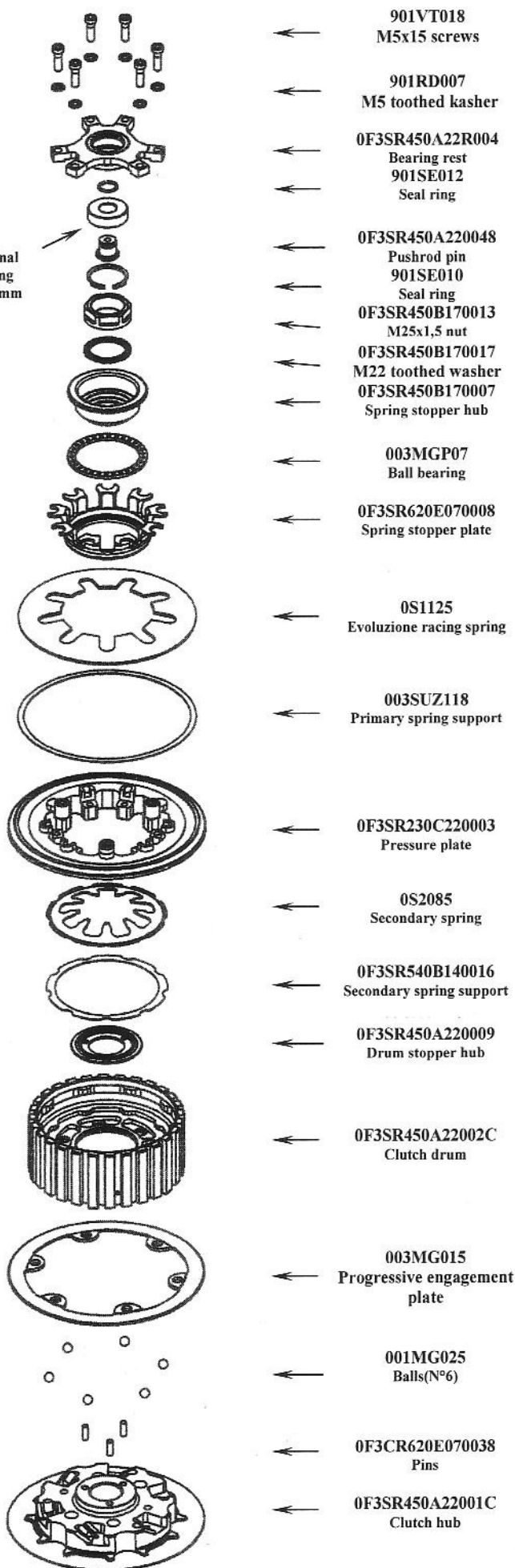

- Pre-assemble the hub pack: put progressive engagement plate (003MG015) on hub (0F3SR450A22001C), with the step facing up, put it correctly into its seats, then check that pushing on one side the other side lifts up. Place at the bottom of the grooves the 6 steel balls (001MG025) onto the hub (0F3SR450A22001C) using a small amount of grease. With an M6 screw fix the clutch drum (0F3SR450A22002C) onto the clutch hub (0F3SR450A22001C) in an at-rest position.
- Insert the hub pack onto the main shaft.
- **Mount the complete plates pack of the MV Agusta F4 1000 removing the two rings.** The total thickness of the pack should be 42.5 mm.
- Remove the screw used to hold hub (0F3SR450A22001C) and drum (0F3SR450A22002C) together.
- Insert the drum stopper hub (0F3SR450A220009) into the hub housing (0F3SR450A22001C) taking care that the three pins (0F3CR620E070038) inside the hub (0F3SR450A22001C) place themselves in the three holes present on the drum stopper hub (0F3SR450A220009) and that they are on a level with the superior surface of the drum stopper hub.
- Verify that the secondary spring support (0F3SR540B140016) is well inserted into its own housing inside the drum (0F3SR450A22002C).
- Insert the secondary spring (0S2085) in its seat into the drum (0F3SR450A22002C) with some grease.
- Verify that the primary spring support (003SUZ118) is well inserted in its own housing inside the pressure plate (0F3SR230C220003).
- Insert the Evoluzione Racing spring (0S1125) into the pressure plate (0F3SR230C220003).
- In order, assemble the complete spring stopper kit starting from the spring stopper plate (0F3CR620E070008) with the shaped part facing up as shown in the picture. Insert the load bearing (003MGP07) and the spring stopper hub (0F3SR450B170007).
- Finally, place the complete spring stopper pack inside the Evoluzione racing spring (0S1125) beforehand mounted onto the pressure plate (0F3SR230C220003). At this point insert the drum (0F3SR450A22002C).
- Insert the notched washer (0F3SR540B170017) in the relevant opening placed on the upper part of the spring stopper hub (0F3SR450B170007), with the convex part facing up, then insert and screw the nut (0F3SR450B170013). Lock with the dynamometric key to the torque suggested by the manufacturer.
- Assemble the complete bearing rest: fit the original bearing in the bearing rest (0F3SR450A22R004). After that insert the seal ring (901SE010) in the groove inside the bearing rest (0F3SR450A22R004). After putting the push rod pin (0F3SR450A220048) in the original bearing, insert the seal ring (901SE012) in its outer groove.
- Position the bearing rest (0F3SR450A22R004) into the relevant opening of the pressure plate (0F3SR230C220003) taking care to correctly align the openings and fix it with the six screws (901VT018) and with the toothed washers (901RD007) with a torque of 2-3Nm.

NB: once the assembly is completed, repeatedly operate the clutch lever to check that pressure plate correctly performs the opening and closing movements.

NORME DI SICUREZZA GENERALI

IL PRESENTE FOGLIO CONTIENE LE ISTRUZIONI PER ESEGUIRE CORRETTAMENTE LE PRINCIPALI OPERAZIONI DI INSTALLAZIONE DELLA FRIZIONE. LA STM SI RISERVA IL DIRITTO DI APPORTARE MODIFICHE IN QUALSIASI MOMENTO AL PRODOTTO SENZA ALCUN OBBLIGO DI AGGIORNAMENTO. LE OPERAZIONI DI MONTAGGIO DEVONO ESSERE SCRUPOLOSAMENTE OSSERVATE ED ESEGUITE ESCLUSIVAMENTE DA UN TECNICO SPECIALIZZATO. PRIMA DI INSTALLARE LA FRIZIONE ESEGUIRE UN CONTROLLO PER VERIFICARE L'EVENTUALE PRESENZA DI GUASTI O ANOMALIE SUL VEICOLO. ACCERTARSI CHE NON CI SIANO PARTI MANCANTI O DANNEGGIATE NELLA CONFEZIONE. ALCUNE PARTI DELLA FRIZIONE E DEI SUOI COMPONENTI POSSONO PRESENTARE SUPERFICI TAGLIANTI: MANEGGIARE CON CAUTELA. ALCUNI COMPONENTI DELLA FRIZIONE PER LE LORO PICCOLE DIMENSIONI POTREBBERO ESSERE INGERITI: TENERE LONTANO DALLA PORTATA DEI BAMBINI.



STRADA S.r.l.

Strada Fontaneto Regione Gionchetto - 10023 Chieri (TO)

Tel +39 011 9422832

Fax +39 011 9471447

Internet: www.stm.to.it

E-mail: info@stm.to.it